



® Automobili Lamborghini S.p.A.

The information and procedures published below are strictly confidential and exclusively for the Lamborghini Dealer Network and Authorized Service Points. All copyrights are property of Automobili Lamborghini S.p.A based on copyright law. All of the PDF chapters in the WEB workshop manuals described below are based on information available at the time of publication. The company reserves the right to make updates and modifications. The following are prohibited: reprinting, reproduction, forwarding to unauthorized people and/or third parties, and translation, including partial, without written authorization from Automobili Lamborghini S.p.A.

Rear Spoiler

An adjustable type spoiler in the rear part of the vehicle allows the correct aerodynamic balancing under any speed.

The spoiler has three different positions according to vehicle speed. The CX oscillates between 0.33 and 0.36 (according to the active air vents position too).

Rear Spoiler (Fig.1)	
A.	Spoiler
B.	Stepping motor
C.	Engine hood

The PCM control unit controls the spoiler stepping motor.

The following table shows the different spoiler positions according to the speed:

Spoiler position	Speed (km/h)	Spoiler condition
0	$V < 130$	CLOSED
1	$130 < V < 220$	OPEN
2	$V > 220$	OPEN

The values stated may vary

Hysteresis when closing is 40 km/h.



- Use the LDAS32 system window (109114) in the case of system malfunctioning or reset.
- In the case of malfunctioning, the relative light on the dashboard will come on .

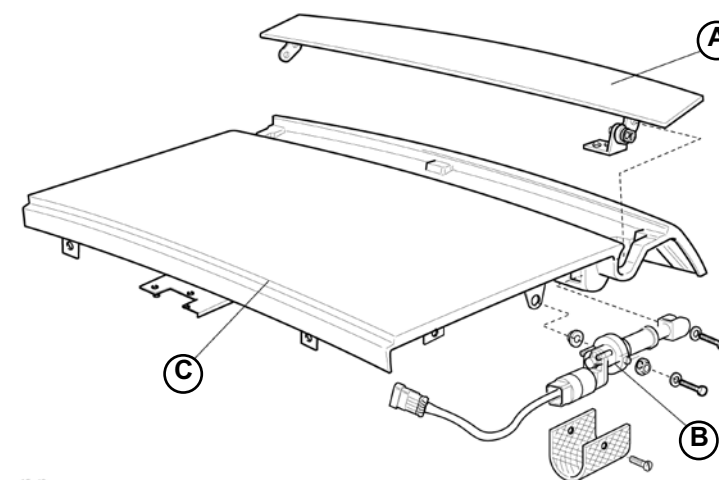

Fig.1